

GENERAL DATA:

Certification	UNI EN 795:2012 UNI CEN/TS 16415:2013 UNI 11578:2015 type A
Product warranty	10 years (upon completion of the certificate included in the package)
Maximum number of users	2 users
Material	AISI 304 stainless steel
Device variants	GstSafe with flat brackets GstSafe with wall brackets GstSafe with inclined brackets
Device weight	12 kg

INSTALLATION EXAMPLES:

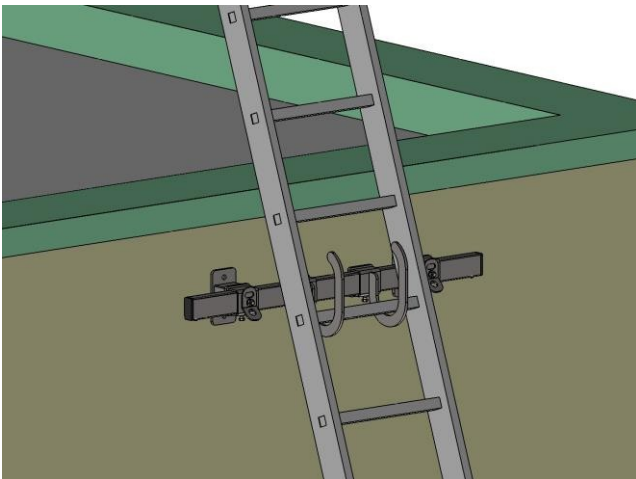

Installation of GstSafe®
on a vertical wall with wall brackets

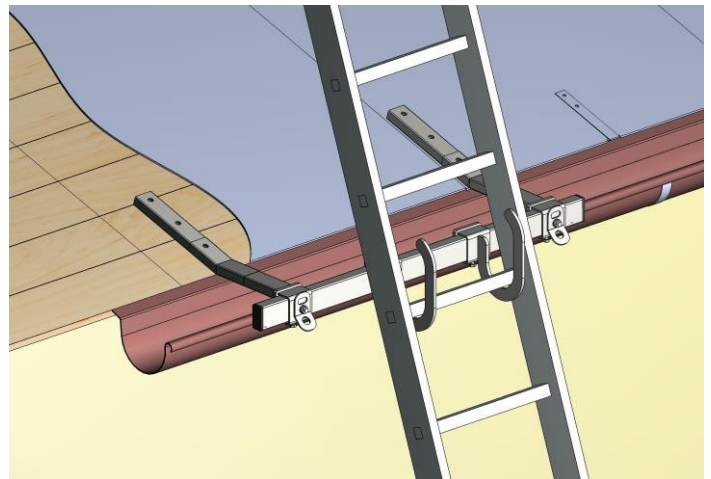

Installation of GstSafe®
on sloped roof with sloped brackets

DIMENSIONS:

Flat brackets

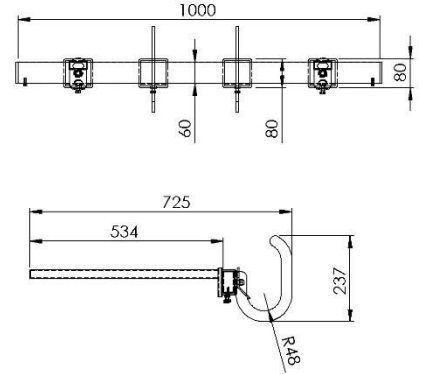
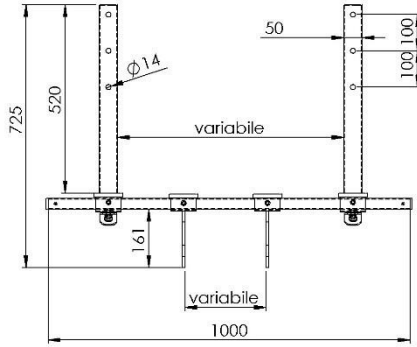
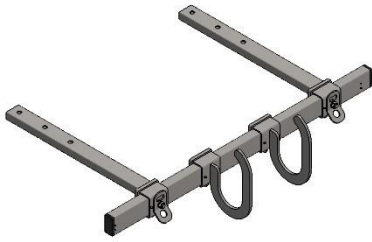

Wall brackets

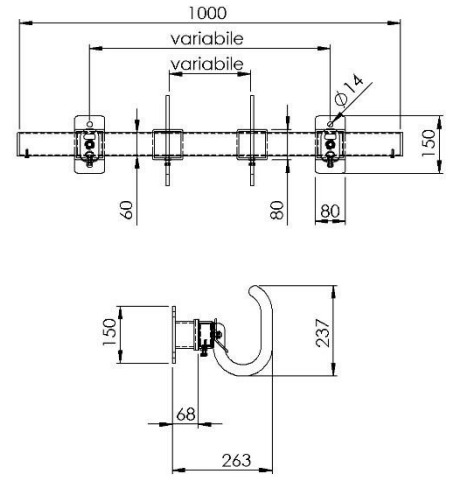
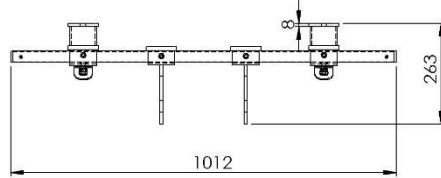
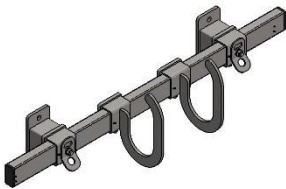

Sloped brackets

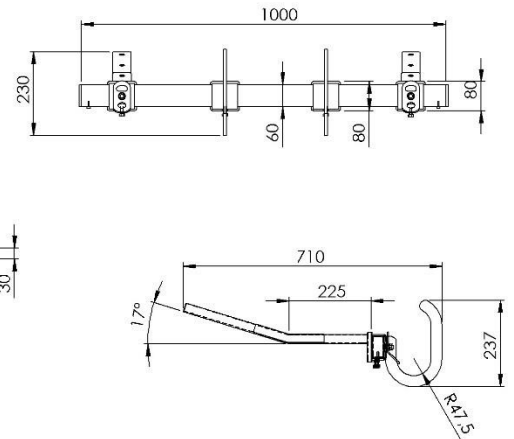
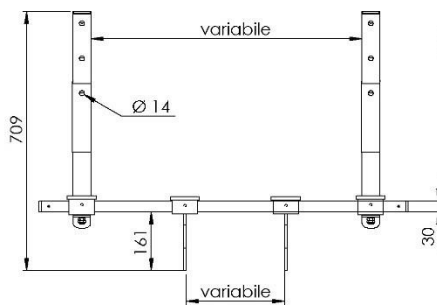
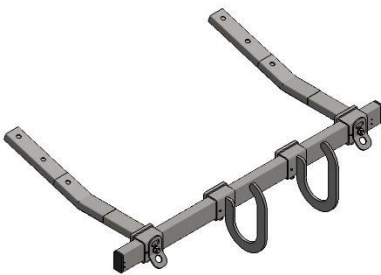

DATA FOR CHECKING FASTENINGS:



The fastening of the GstSafe device to the load-bearing structural element must be checked by a qualified technician before installation.

The design force to be considered for the calculation of the fastening is 9 kN (according to UNI EN 795:2012) **or 12 kN** (according to CEN/TS 16415:2013 and UNI 11578:2015 for 3 simultaneous operators), applied to the anchor point.

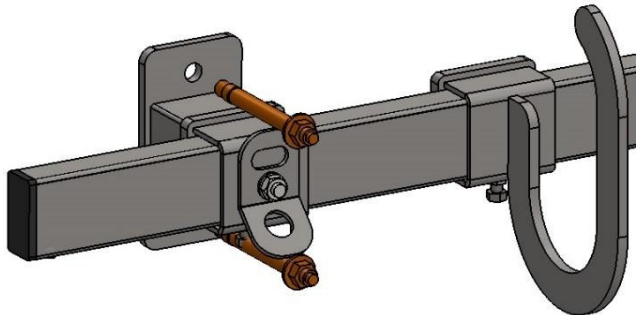
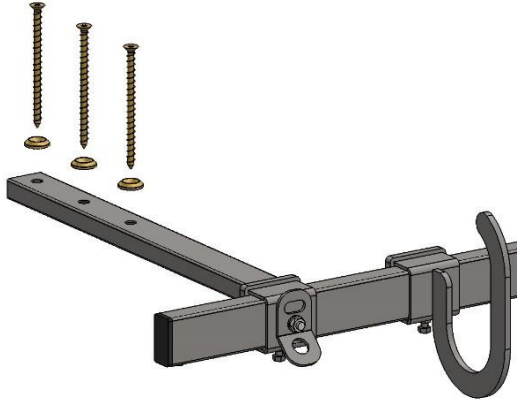
FASTENING EXAMPLES:

	
<p>Fastening on concrete with mechanical anchors or chemical anchors</p>	<p>Fixing the flat bracket device to wood</p>

COMPLETE DEVICE COMPONENTS:

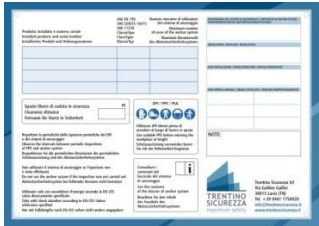
		
<p>Installation, use, and maintenance manual periodic checks</p>	<p>Certification test certificate</p>	<p>Signaling table</p>